

Zoning Information

8 Heather Place Brampton

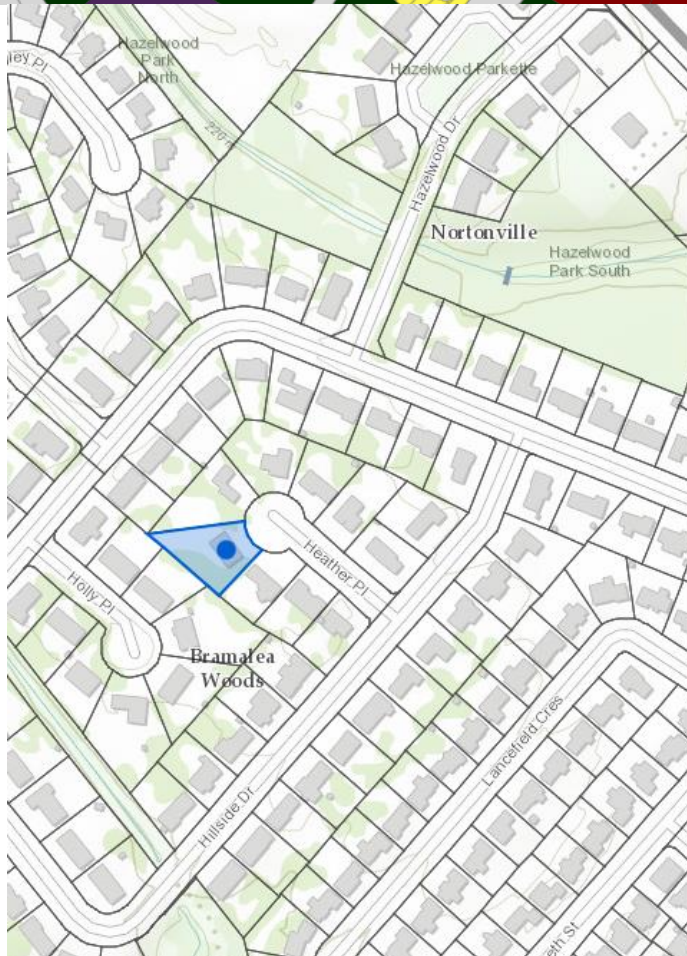
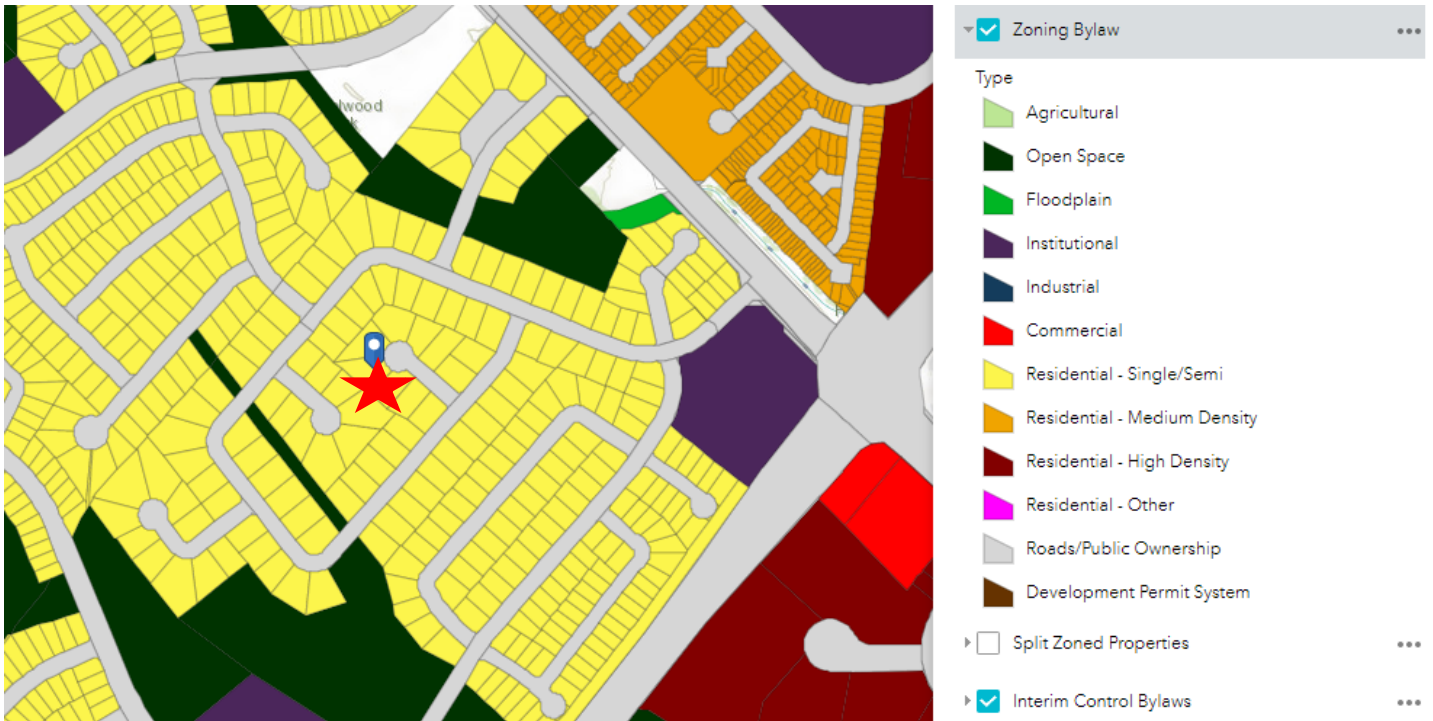

Property Report

8 HEATHER PL Clear

BRAMPTON, ON, L6S1E8

Roll Number: 10-09-0-023-19000-0000
Ward: 7
Property Description:

Councillors ▼

Parks ▼

Schools ▼

Businesses ▼

Planning ▼

Zoning ▲

Zone Code: R1A(2)
Category: [RESIDENTIAL](#)
Type: [R1A\(2\)](#)
Special Section:
Split Zoned: NO

This version of consolidated zoning is for convenience purposes only. For more information and interpretation, please contact City Zoning staff at 905-874-2090.

R1A - Residential Zone



(204-2010)(253-2021)

SECTION 12.3 RESIDENTIAL SINGLE DETACHED A(2) – R1A(2) ZONE

The lands zoned R1A(2) on Schedule A to this by-law:

12.3.1 shall only be used for the following purposes:

(a)		<u>Residential</u>
	(1)	a single detached dwelling
	(2)	Supportive Housing Residence Type 1
(b)		<u>Non-Residential</u>
	(1)	a place of worship
	(2)	purposes accessory to the other permitted purposes

12.3.2 shall be subject to the following requirements and restrictions:

(a)	Minimum Lot Area	882 square metres
(b)	Minimum Lot Width	22 metres
(c)	Minimum Lot Depth	No requirement
(d)	Minimum Front Yard Depth	9 metres
(e)	Minimum Interior Side Yard Width	1.8 metres for the 1 st storey or part thereof plus 0.6 metres for each additional storey or part thereof
(f)	Minimum Exterior Side Yard Width	4.5 metres
(g)	Minimum Rear Yard Depth	7.5 metres
(h)	Maximum Building Height	7.6 metres
(i)	Maximum Lot	25%

Coverage	
(j) Minimum Landscaped Open Space	70% of the front yard, except in the case of the lot where the side lot lines converge towards the front lot line, where the minimum landscaped open space shall be 60% of the front yard