

Well Title	Number (below)
A 024554	
A 024554	

Instructions for Completing Form

- For use in the Province of Ontario only. This document is a permanent legal document. Please retain for future reference.
- All Sections must be completed in full to avoid delays in processing. Further instructions and explanations are available on the back of this form.
- Questions regarding completing this application can be directed to the Water Well Management Coordinator at 416-235-6203.
- All metre measurements shall be reported to 1/10th of a metre.
- Please print clearly in blue or black ink only.

MUN						CON						LOT					
Ministry Use Only																	
Well Owner's Information and Location of Well Information																	
First Name Greg				Last Name Wollerman				Mailing Address (Street Number/Name, RR, Lot, Concession) 291 Old Hungerford Rd.				Telephone Number (include area code) 613 478 4703					
County/District/Municipality Hastings				Township/City/Town/Village Roslin				Province Ontario				Postal Code KOR 2Y0					
Address of Well Location (County/District/Municipality) Hastings						Township Hungerford						Lot 6					
RR#/Street Number/Name 136 Old Hungerford Rd						City/Town/Village Roslin						Site/Compartment/Block/Tract etc. II					
GPS Reading		NAD		Zone		Easting		Northing		Unit Make/Model		Mode of Operation:		<input type="checkbox"/> Undifferentiated		<input checked="" type="checkbox"/> Averaged	
		8.3		18		316912		4916798		Garmin ETREX				<input type="checkbox"/> Differentiated, specify			

Log of Overburden and Bedrock Materials (see instructions)				Depth From	Metres To
General Colour	Most common material	Other Materials	General Description		
Brown	Loam	Boulders	Packed	0	2.1
Grey	Limestone		Hard	2.1	47.5
Grey	Granite		Hard	47.5	55.7

Hole Diameter		
Depth From	Metres To	Diameter Centimetres
0	6	25.4
6	55.7	15.5
Water Record		
Water found at	Kind of Water	
15.0	Untested	
53.6	Untested	
Gas	Sulphur	Minerals
Other	Salty	
Gas	Fresh	Sulphur
Other	Salty	Minerals
After test of well yield, water was		
<input checked="" type="checkbox"/> Clear and sediment free		
<input type="checkbox"/> Other, specify		
Chlorinated	<input checked="" type="checkbox"/> Yes <input type="checkbox"/> No	

Construction Record					
Inside diam centimetres	Material	Wall thickness centimetres	Depth From	Metres To	
15.8	Steel Fiberglass	.48	0	6.7	
Casing					
<input checked="" type="checkbox"/> Steel <input type="checkbox"/> Fiberglass <input type="checkbox"/> Plastic <input type="checkbox"/> Concrete <input type="checkbox"/> Galvanized <input type="checkbox"/> Steel <input type="checkbox"/> Fiberglass <input type="checkbox"/> Plastic <input type="checkbox"/> Concrete <input type="checkbox"/> Galvanized <input type="checkbox"/> Steel <input type="checkbox"/> Fiberglass <input type="checkbox"/> Plastic <input type="checkbox"/> Concrete <input type="checkbox"/> Galvanized					
Screen					
Outside diam	Steel Fiberglass	Slot No			
	Plastic Concrete				
	Galvanized				
No Casing or Screen					
	<input checked="" type="checkbox"/> Open hole		6	55.7	

Test of Well Yield				
Pumping test method	Draw Down		Recovery	
	Time min	Water Level Metres	Time min	Water Level Metres
Pump				
Pump intake set at - (metres)	54.8	Static Level	4.0	9.5
Pumping rate - (litres/min)	36.3	1	5.1	7.9
Duration of pumping	1 hrs + 0 min	2	5.9	7.0
Final water level end of pumping	9.5 metres	3	6.4	6.5
Recommended pump type		4	6.8	6.3
Recommended pump depth	53.3 metres	5	7.1	6.1
Recommended pump rate	68.2 (litres/min)	10	7.5	5.6
		15	8.1	5.5
If flowing give rate - (litres/min)		20	8.4	5.3
		25	8.6	5.2
If pumping discontinued, give reason.		30	8.8	5.1
		40	9.1	5.0
		50	9.3	4.9
		60	9.5	4.9

Plugging and Sealing Record		
Depth set at - Metres	Material and type (bentonite slurry, neat cement slurry) etc	Volume Placed (cubic metres)
6	0 Bentonite	.24
<input checked="" type="checkbox"/> Annular space <input type="checkbox"/> Abandonment		

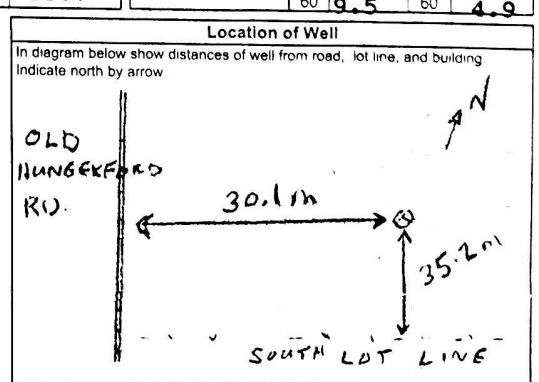

Method of Construction			
<input type="checkbox"/> Cable Tool	<input checked="" type="checkbox"/> Rotary (air)	<input type="checkbox"/> Diamond	<input type="checkbox"/> Digging
<input type="checkbox"/> Rotary (conventional)	<input type="checkbox"/> Air percussion	<input type="checkbox"/> Jetting	<input type="checkbox"/> Other
<input type="checkbox"/> Rotary (reverse)	<input type="checkbox"/> Boring	<input type="checkbox"/> Driving	
Water Use			
<input checked="" type="checkbox"/> Domestic	<input type="checkbox"/> Industrial	<input type="checkbox"/> Public Supply	<input type="checkbox"/> Other
<input type="checkbox"/> Stock	<input type="checkbox"/> Commercial	<input type="checkbox"/> Not used	
<input type="checkbox"/> Irrigation	<input type="checkbox"/> Municipal	<input type="checkbox"/> Cooling & air conditioning	
Final Status of Well			
<input checked="" type="checkbox"/> Water Supply	<input type="checkbox"/> Recharge well	<input type="checkbox"/> Unfinished	<input type="checkbox"/> Abandoned, (Other)
<input type="checkbox"/> Observation well	<input type="checkbox"/> Abandoned, insufficient supply	<input type="checkbox"/> Dewatering	
<input type="checkbox"/> Test Hole	<input type="checkbox"/> Abandoned, poor quality	<input type="checkbox"/> Replacement well	

Audit No	Z 23699	Date Well Completed	YYYY MM DD
Was the well owner's information package delivered?	<input checked="" type="checkbox"/> Yes <input type="checkbox"/> No	Date Delivered	2005 08 30

Well Contractor/Technician Information	
Name of Well Contractor CHALK WELL DRILLING LTD.	Well Contractor's Licence No. 1507
Business Address (street name, number, city, etc.) R. R. # 6, Napanee, Ontario	
Name of Well Technician (last name, first name) Kevin Chalk	Well Technician's Licence No. T-0627
Signature of Technician/Contractor	Date Submitted 2005 08 30
CHALK WELL DRILLING LTD.	

Ministry Use Only			
Data Source	Contractor		
Date Received	YYYY MM DD	Date of Inspection	YYYY MM DD
Remarks	Well Record Number		